

fluticasone & salmeterol Respclick (generic)

55/14mcg (low dose light orange label)

113/14mcg (medium dose (green label)

232/14mcg (high dose) (dark orange label)



Medicine	Need a spacer?	My dose
Controller (dry powder inhaler)	No	Check Asthma Action Plan

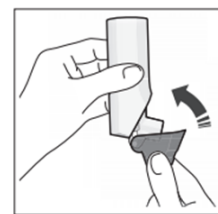
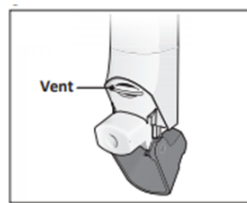
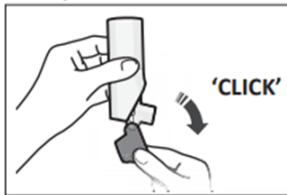

1. Holding RespClick upright, open red cap until you hear a click
2. Exhale away from device
3. Place mouth over mouthpiece with a tight seal (do not block vent with mouth or fingers)
4. Inhale quickly and deeply
5. Hold breath as long as you can, around 10 seconds
6. Remove RespClick from mouth and exhale slowly away from device.
7. Place cap back on until it clicks closed
8. Steps 1-7 for each dose

Use the camera on your phone to scan this QR code for the Generic AirDuo Website:

There is information about:

- ◆ How to use Generic AirDuo Respclick
 - ◆ Click “menu” then click “Using AirDuo”
- ◆ To save money:
 - ◆ Click on “menu” then click “low cost” for a co-pay card



1/6/2021